

FITTING INSTRUCTIONS

Part Number - DA1125

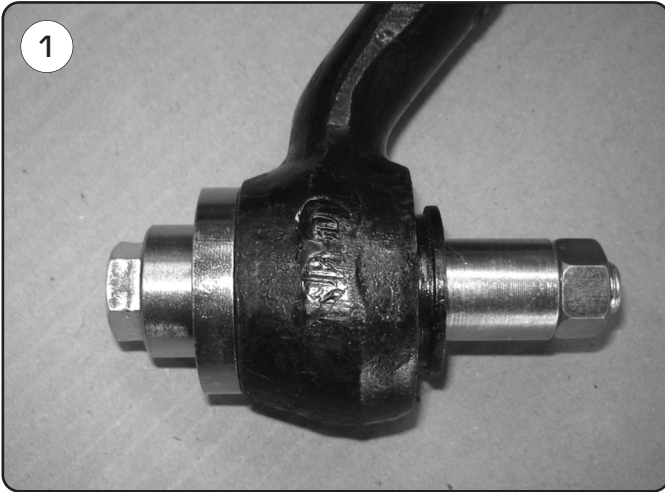

This tool can be used with the drop arm fitted on or off the vehicle. If the arm is still on the vehicle remove the steering rod first.

Dismantling

Remove the gaiter from the top of the drop arm, then remove the circlip from the bottom. Using a hammer tap out the ball joint assembly.

Using the tool assembled as (pic 1) tighten the bolt up to remove the upper cone of the joint. Note which way around it is fitted.

Clean the inside of the drop arm out using some emery, cleaning fluid and cloth.

Re-assembly (pic 2)

This is the correct order of assembly. First get the upper cone and put it into the drop arm the correct way around, if it goes up to the seating face and moves freely then the arm needs replacing. If it doesn't then remove the upper cone and apply a small amount of grease to the outer edge of the cone and refit it into the drop arm larger diameter out, using the tool assembled as in (pic 3) to pull the cone up against the seating face.

Re-assemble and grease the rest of the joint as in pic 2, centre pin, bottom cone, spring, seal, cover and circlip.

To help compress the spring to fit the circlip you can use a puller as shown in pic 4.

Fit the seal to the top of the drop arm, fit the larger spring clip first then the smaller one.

Refit the steering rod and tighten the nut to 40nm (30lbs ft) and fit the cotterpin.

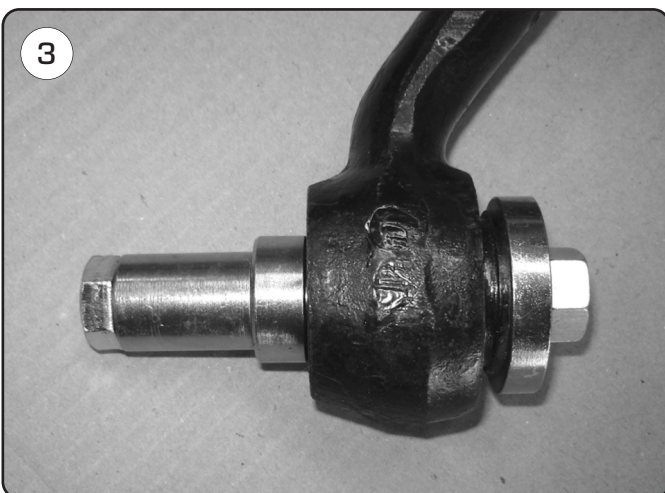
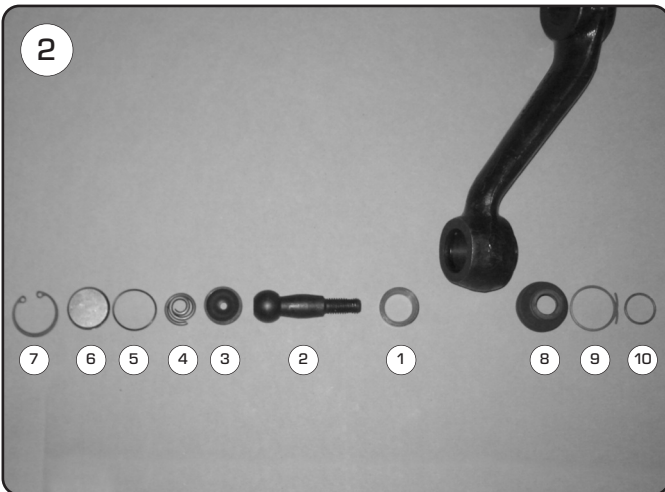

Disclaimer

These fitting instructions are intended for general guidance only. No responsibility will be accepted for damage to persons, property, equipment or vehicles caused during or arising from the fitment or using of this product. Fitting this item to your vehicle may constitute a vehicle modification and therefore we strongly recommend that you check the product complies with local laws and legislation and always inform the vehicle's insurance company accordingly. Vr. 1.